

## FASEGRAPH® DEVICE FOR PREVENTIVE AND CLINICAL MEDICINE

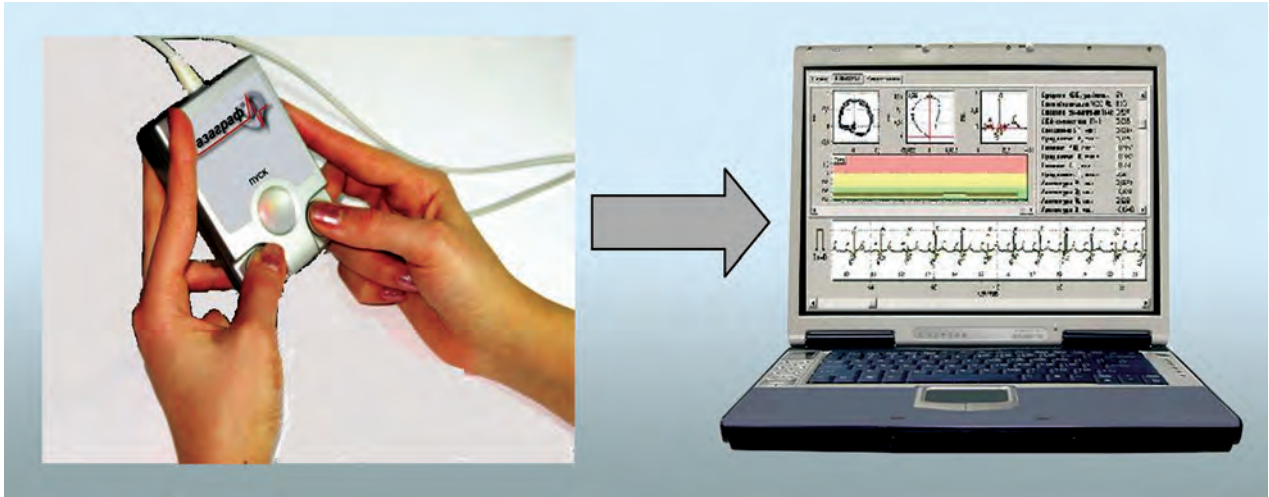

### Areas of Application

The device is to be used at medical, educational, sports institutions, at home and in the field conditions to evaluate the functional state of the cardiovascular system, including to make screening for coronary heart disease; to carry out mass preventive surveys; to obtain additional diagnostic information during exercise tests; to control the cardiovascular dynamics in the treatment of cardiological diseases

### Specification

The device consists of a microprocessor sensor for recording electrocardiograms (ECG) using finger electrodes and computer programs based on innovative method for ECG processing.  
The test duration is 2 minutes.  
The sensitivity and specificity exceed 93%

### Advantages

Unlike the known analogs, FASEGRAPH® enables to determine subtle changes in signal, which give additional diagnostic information, but are not taken into account in the conventional traditional ECG diagnosis

### Stage of Development. Suggestion for Commercialization

IRL6, TRL8  
Manufacture, supply, warranty service, and staff training, upon request

### IPR Protection

IPR1, IPR3

### Contact Information:

Leonid S. Fainzilberg, International Research and Training Center for Information Technologies and Systems of the NAS of Ukraine and the Ministry of Education and Science of Ukraine; +38 044 526 11 54, e-mail: fainzilberg@voliacable.com